



✿ JSW APPLICATION

Adjustable swirl diffusers are designed for air-conditioning space with varying heat loads.

Due to the rotary swirling motion of the air discharge, induction of room air occurs very quickly. Adjustable swirl diffuser is suitable for use in industrial and comfort conditioning environments.

✿ JSW STANDARD CONSTRUCTION / FEATURES

- The JSW is constructed of galvanized sheet steel. The surface is phosphate treated and powder coated white RAL 9010.
- The diffuser face includes adjustable blades and outer discharge nozzle and has a rear mounted circular housing.
- The blades' positions are adjustable manually.
- The JSW can be supplied with plenum box made of galvanized steel sheet with either top or side inlet.



✿ JSW OPTIONS

- Plenum Box w/o Insulation (PB).
- Plenum Box c/w 5mm P.E foam Insulation (PBL).

✿ JSW PRODUCT SIZES

Size	PRODUCT SIZE DETAILS								
	B	D	H1	H2	H3	L	D1	D2	T
315	315	380	480	203	425	435	480	250	63
400	400	464	600	238	530	500	565	300	80
500	500	565	700	285	630	600	665	350	100
630	630	708	850	383	750	750	871	400	125
800	800	871	1130	568	1000	1000	1077	500	160

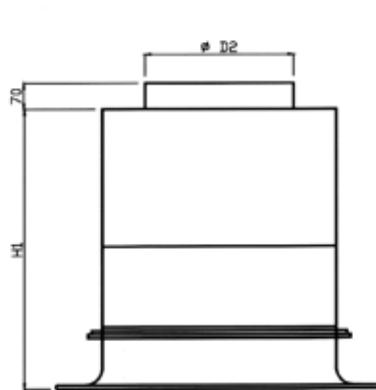
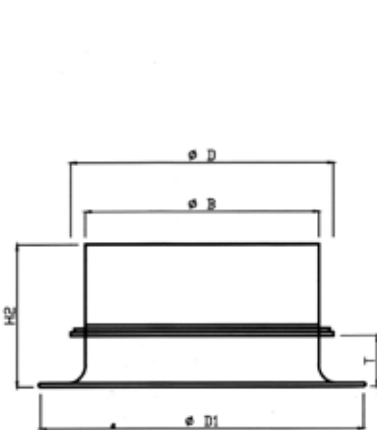

Vertical Inlet

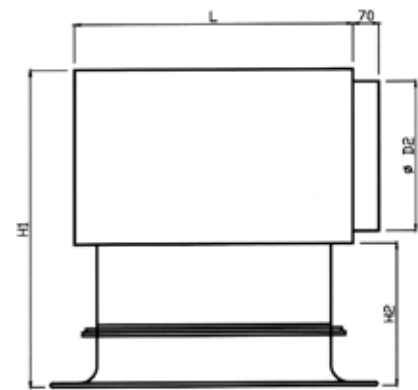

Horizontal Inlet

✿ JSW ORDER KEY INFORMATION

JSW - S + PBH

Accessories	PBV- Plenum Box c/w vertical inlet, PBH- Plenum Box c/w Horizontal inlet
Material	Galvanized Steel (S)
Model	JSW – Swirl Vanes Round Diffuser

✿ JSW PERFORMANCE DATA

Size	CFM	170	210	255	296	340	380	420
Ø 315	TP	0.032	0.052	0.072	0.100	0.128	0.160	0.200
AK 0.293	NC	--	16	22	26	31	34	38
	Throw V	5-9	7-13	9-17	10-20	11-22	13-24	14-26
	Throw H	4-7	5-8	5-9	6-11	6-12	7-13	8-14
Size	CFM	420	530	635	740	850	950	1060
Ø 400	TP	0.032	0.052	0.076	0.104	0.136	0.172	0.212
AK 0.549	NC	--	16	23	27	31	34	39
	Throw V	11-22	14-25	17-33	20-40	23-46	25-51	28-56
	Throw H	6-12	7-14	8-16	9-18	10-20	11-22	13-24
Size	CFM	655	750	845	640	1125	1345	1500
Ø 500	TP	0.036	0.048	0.061	0.075	0.108	0.155	0.192
AK 0.938	NC	--	17	21	25	31	36	40
	Throw V	12-24	14-27	17-35	20-40	22-43	26-52	28-56
	Throw H	6-13	2-75	8-16	9-18	10-19	11-23	13-24
Size	CFM	740	850	950	1060	1270	1480	1700
Ø 630	TP	0.032	0.044	0.056	0.068	0.096	0.128	0.168
AK 1.055	NC	--	15	18	22	28	33	37
	Throw V	12-23	12-25	17-33	20-40	22-43	25-50	28-56
	Throw H	6-13	7-14	8-16	39-17	9-19	11-22	13-24
Size	CFM	850	1060	1270	1480	1700	1900	2100
Ø 800	TP	0.032	0.052	0.072	0.100	0.128	0.164	0.196
AK 1.216	NC	15	21	27	32	37	41	45
	Throw V	11-22	14-25	16-31	19-38	22-45	24-50	27-55
	Throw H	6-13	7-14	8-15	9-17	10-19	11-21	13-24

Notes:

- Total Pressure is in Inch of Water, Air volume is in CFM.
- Ak - Area factor in ft²
- NC values were determined by subtracting 10 dB from the power level for room absorption.
- Dash (-) in space denote an NC values of less than 15.
- Throw data is given for terminal velocities of 100 and 50 ft./min. Throw values are given for Isothermal conditions.
- Throw values are given for Vertical Throw (blade position at 75°) & Horizontal Throw (blade position at 45°).
- Actual performance with plenum & flexible duct may vary in field.